

# E5 BT A18 E5 BT A12

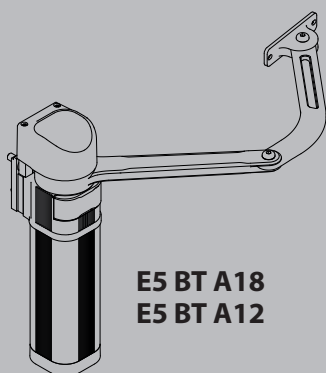

24 V



E5 BT A18  
E5 BT A12

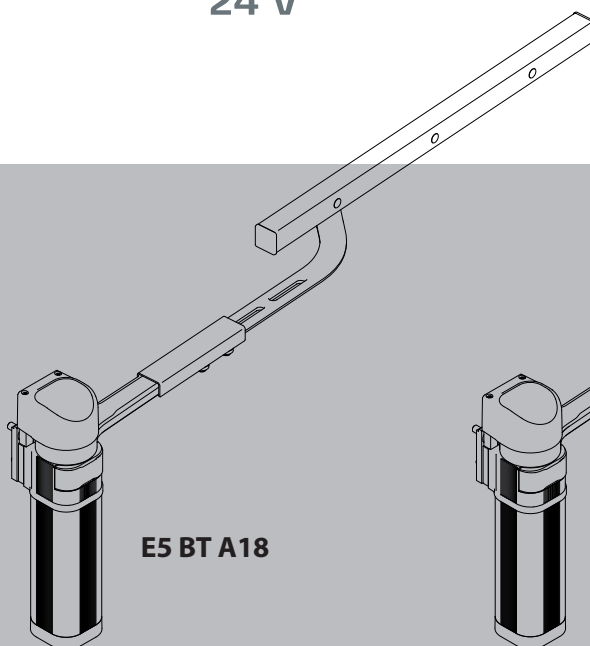

E5 BT A18

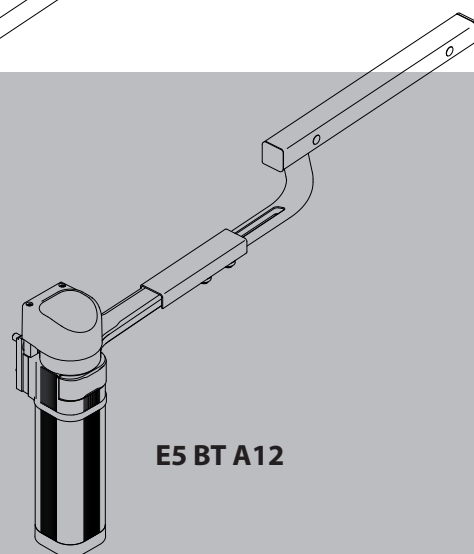

E5 BT A12

D814068 0AA00\_04 19-03-20

## INSTALLATION AND USER'S MANUAL

## ARM AUTOMATIONS FOR SWING GATES

**Caution!** Read "Warnings" inside carefully!



AZIENDA CON  
SISTEMA DI GESTIONE  
CERTIFICATO DA DNV GL  
= ISO 9001 =  
= ISO 14001 =



8 027908 556820 >



## 1) IN GENERAL

The E5 automation consists of a compact electromechanical gear motor of minimum size, which can be applied on any pillar or column, due to its versatility. The locking of the gate at closing is ensured by an electric lock, and the manual emergency maneuverer can be easily performed, after having unlocked the electric lock using the personalized key provided, thanks to the reversibility of the gear motor.

Total safety against crushing is ensured by a multiple disc clutch, and the end-of-stroke operation is regulated with an encoder.

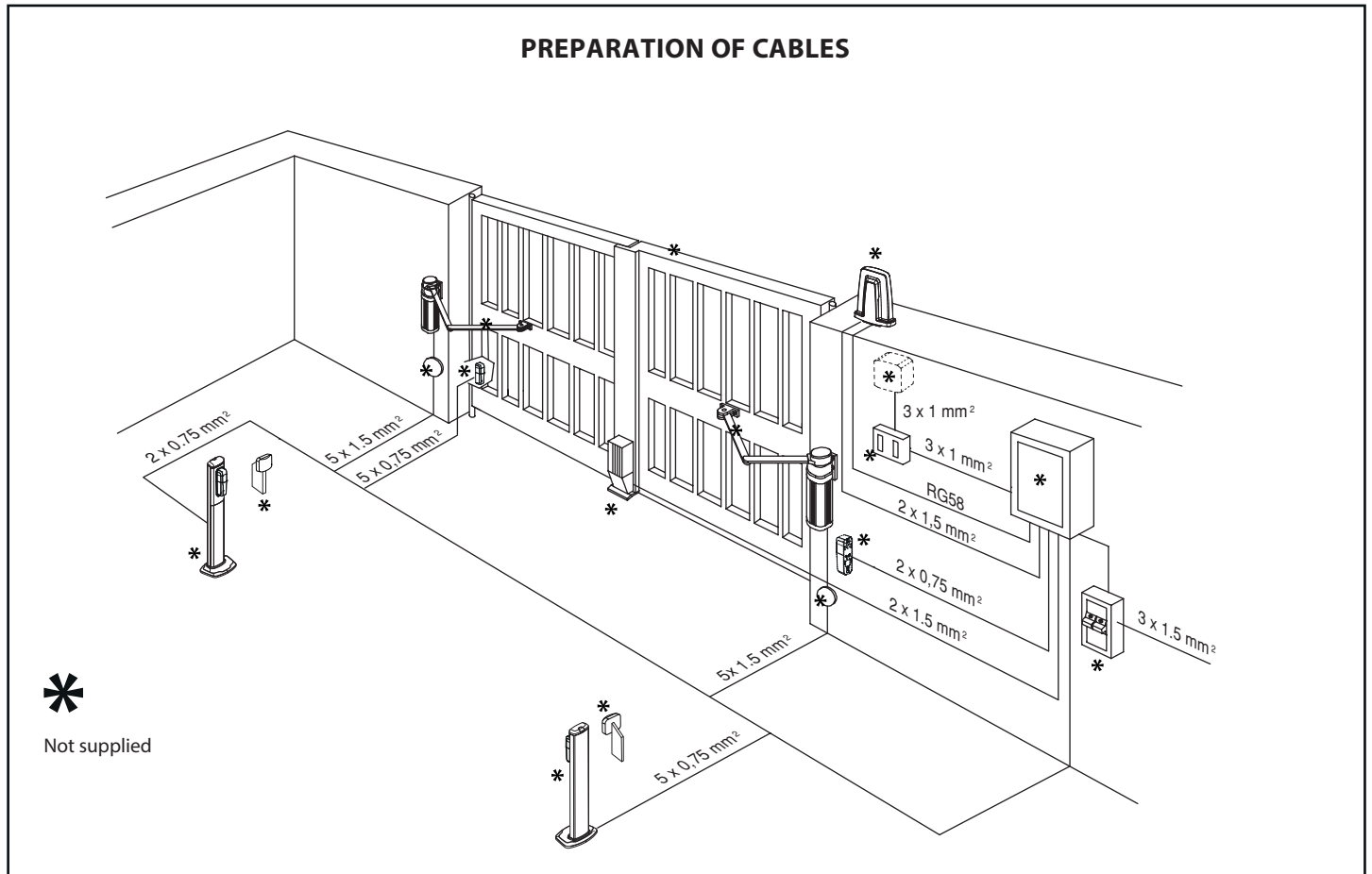

# PACKAGE CONTENTS

**E5 BT A18**  
**E5 BT A12**

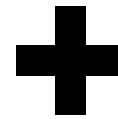
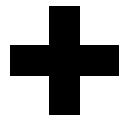
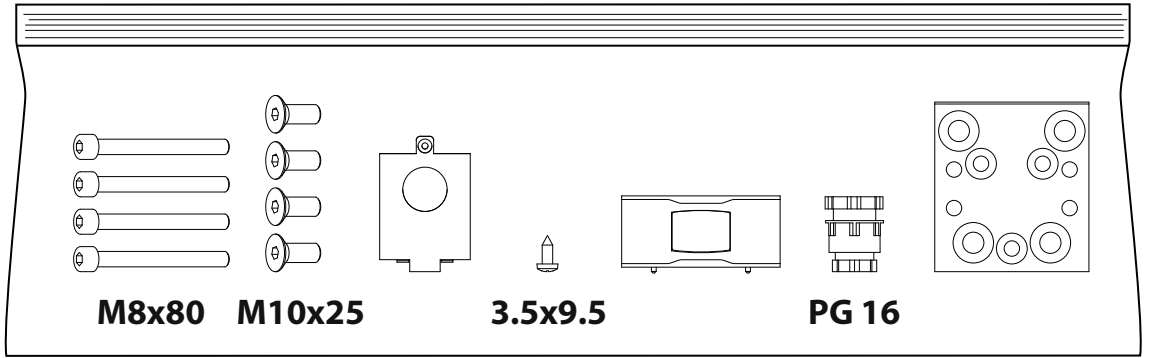
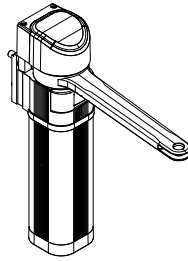

**E5 BT A18**

**E5 BT A18**

**E5 BT A12**

**E5 BT A12**

**ACCESSORY ARM NOT SUPPLIED**

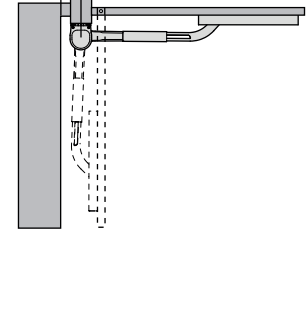
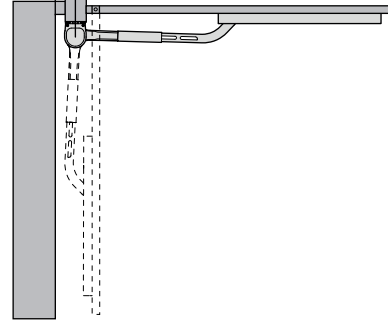
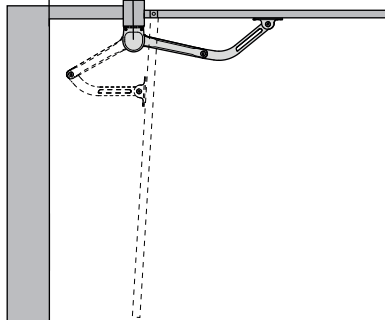
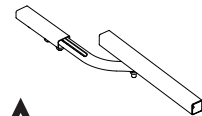
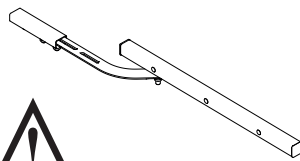

Articulated Arm

Sled Arm

Sled Arm

# EQUIPMENT

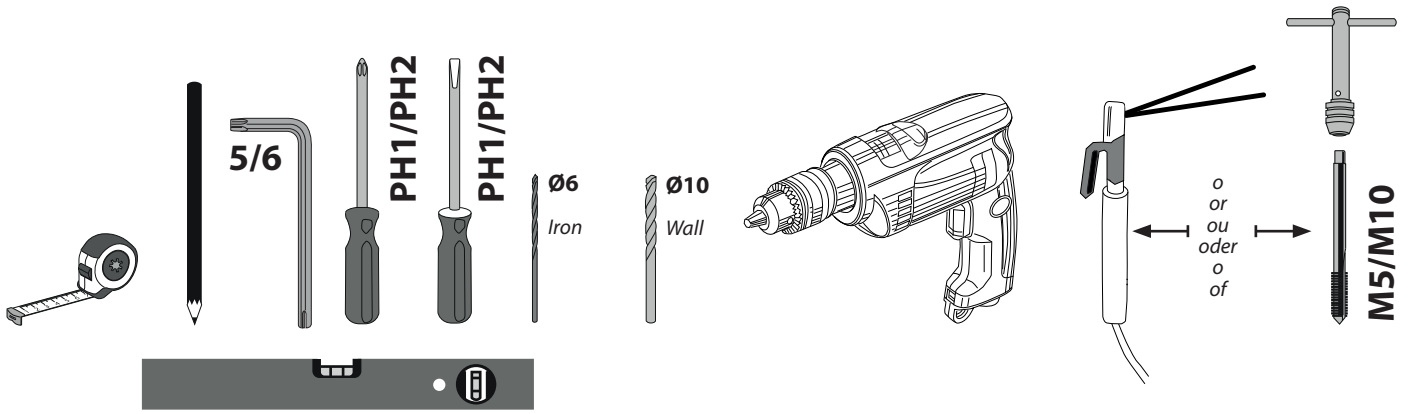

# DIMENSIONS

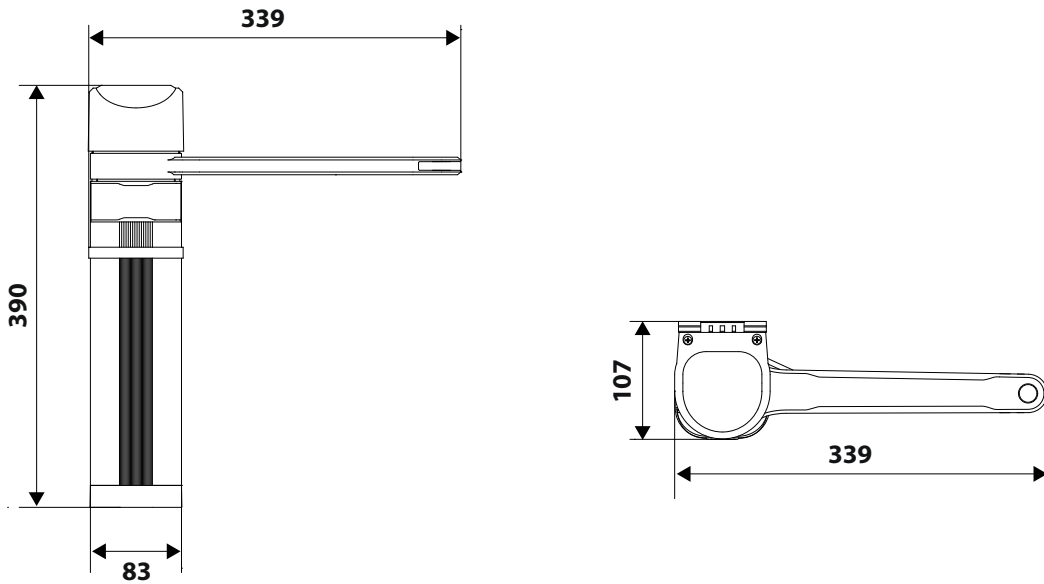

# ACCESSORY ARTICULATED ARM FOR E5 BT A18 / E5 BT A12

## PACKAGE CONTENTS

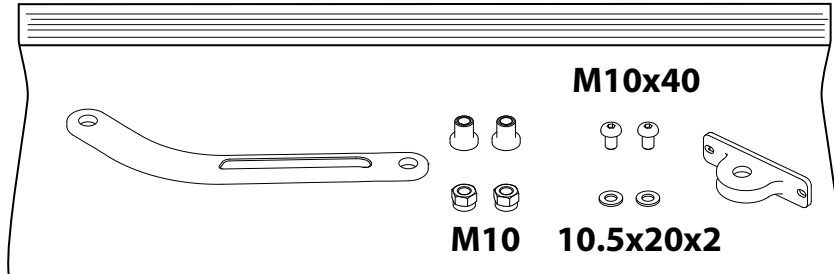

## EQUIPMENT

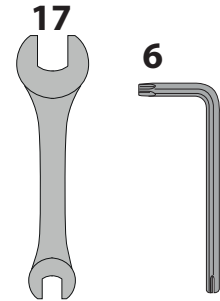

## DIMENSIONS

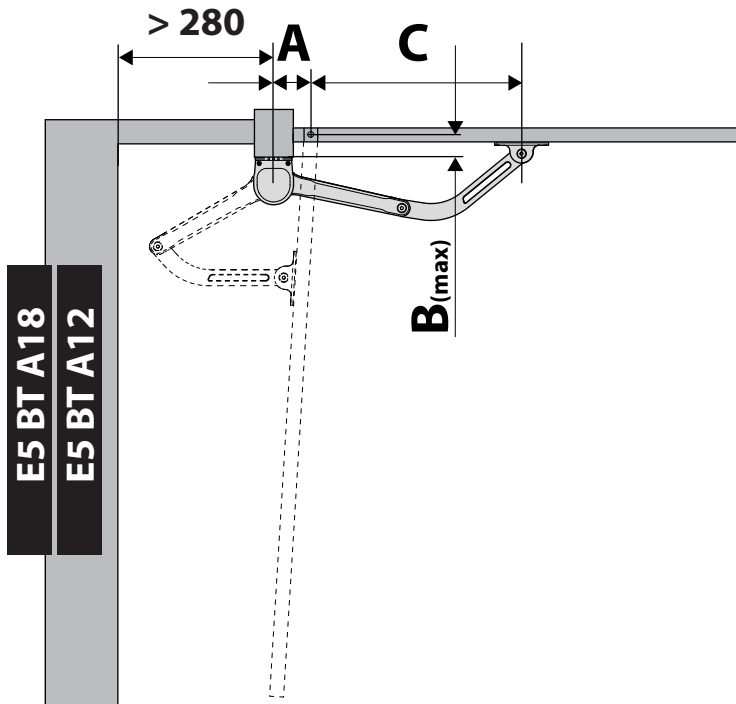

A+C 470 ÷ 530

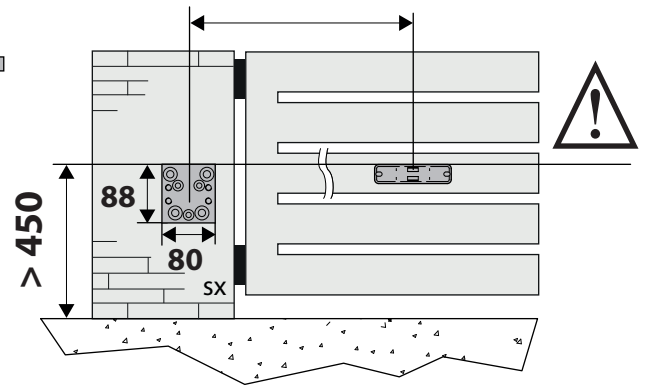

**WARNING! Place the bracket on the full part of the gate.**

		A							
		120	140	150	160	170	180	190	200
B	30	125°	130°	134°	134°	137°	139°	141°	142°
	40	122°	128°	130°	133°	135°	137°	139°	140°
	50	120°	126°	128°	131°	133°	135°	136°	138°
	60	118°	124°	125°	130°	131°	133°	134°	136°
	70	116°	122°	124°	128°	129°	131°	132°	134°
	80	114°	120°	123°	127°	128°	129°	130°	132°
	90	113°	118°	122°	125°	126°	127°	128°	130°
	100	112°	117°	120°	124°	124°	125°	127°	128°
	110	110°	116°	119°	122°	122°	123°	125°	126°
	120	109°	114°	118°	121°	121°	121°	123°	124°
	130	108°	113°	115°	119°	119°	120°	121°	122°
	140	107°	112°	115°	118°	117°	118°	119°	120°
	150	107°	111°	114°	116°	116°	116°	117°	118°
	160	106°	110°	113°	115°	114°	114°	116°	117°
	170	105°	109°	112°	114°	112°	113°	114°	115°
	180	104°	109°	110°	112°	111°	111°	112°	113°
	190	104°	108°	110°	111°	109°	109°	110°	111°
200	103°	107°	107°	110°	108°	108°	109°	110°	

# ACCESSORY SLED ARM FOR E5 BT A18

## PACKAGE CONTENTS

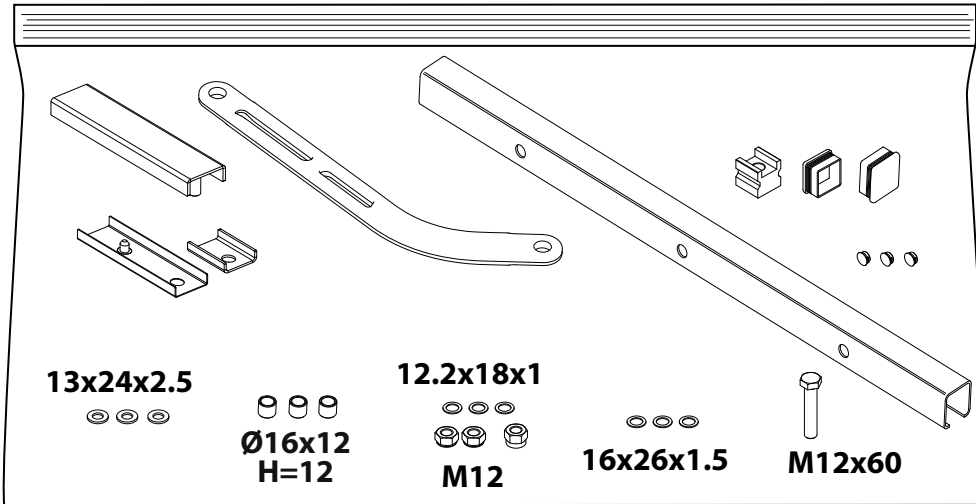

## EQUIPMENT

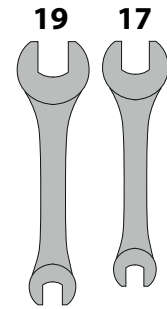

## DIMENSIONS

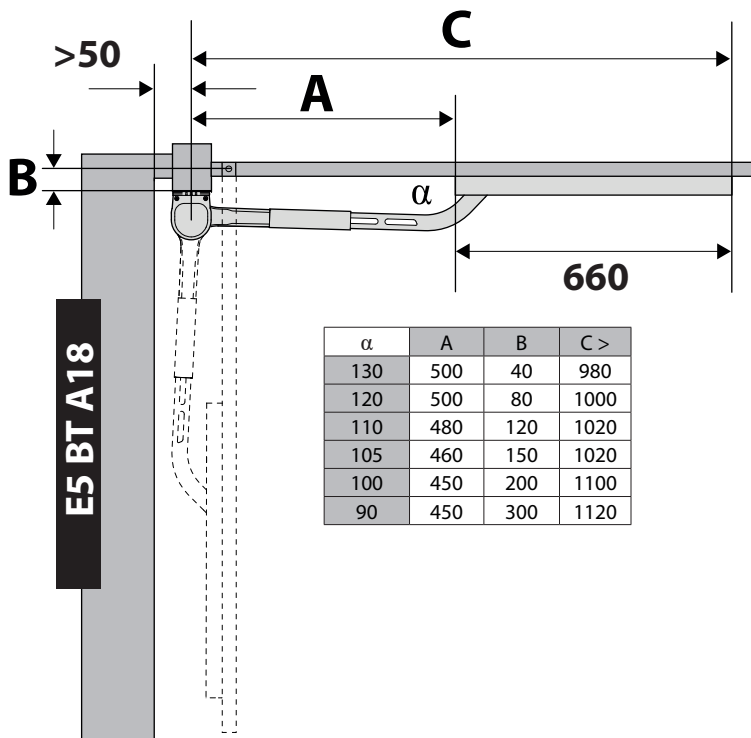

α	A	B	C >
130	500	40	980
120	500	80	1000
110	480	120	1020
105	460	150	1020
100	450	200	1100
90	450	300	1120

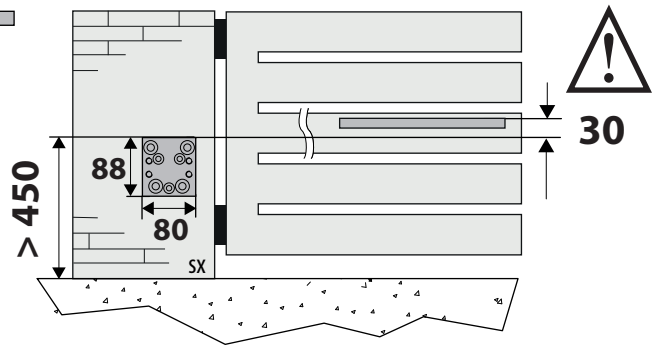

WARNING! Place the bracket on the full part of the gate.

# ACCESSORY SLED ARM FOR E5 BT A12

## PACKAGE CONTENTS

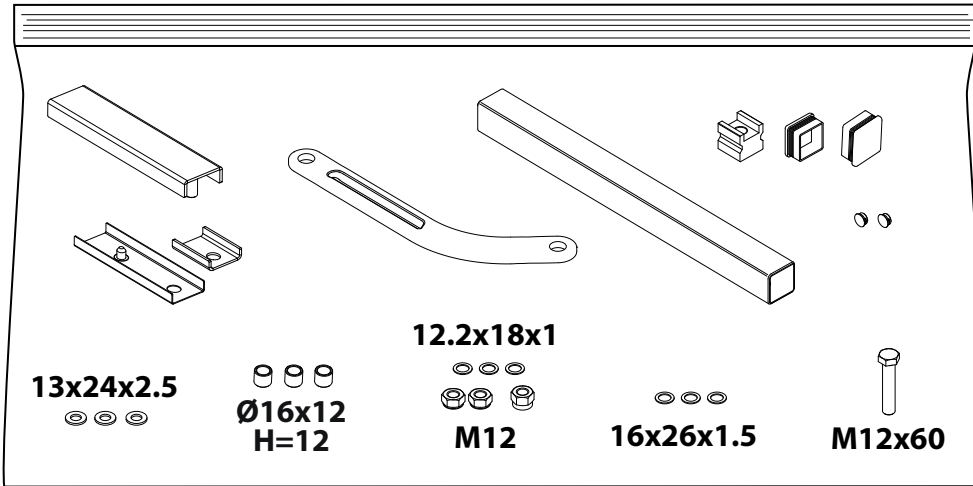

## EQUIPMENT

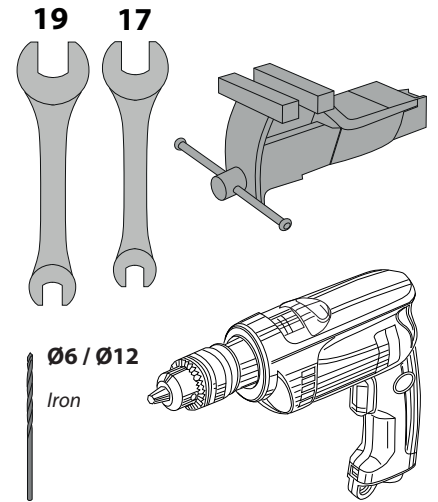

## DIMENSIONS

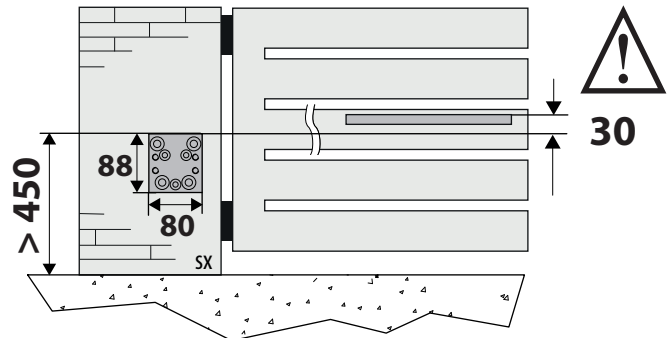
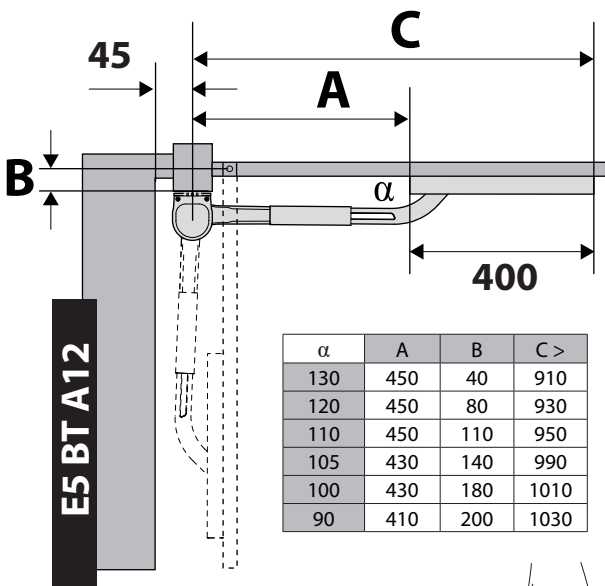

**WARNING!** Place the bracket on the full part of the gate.

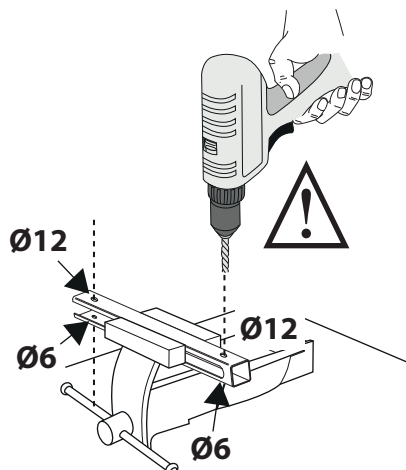

**A**

### FASTENING OF MOTOR HOLDER PLATE

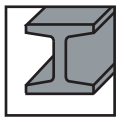
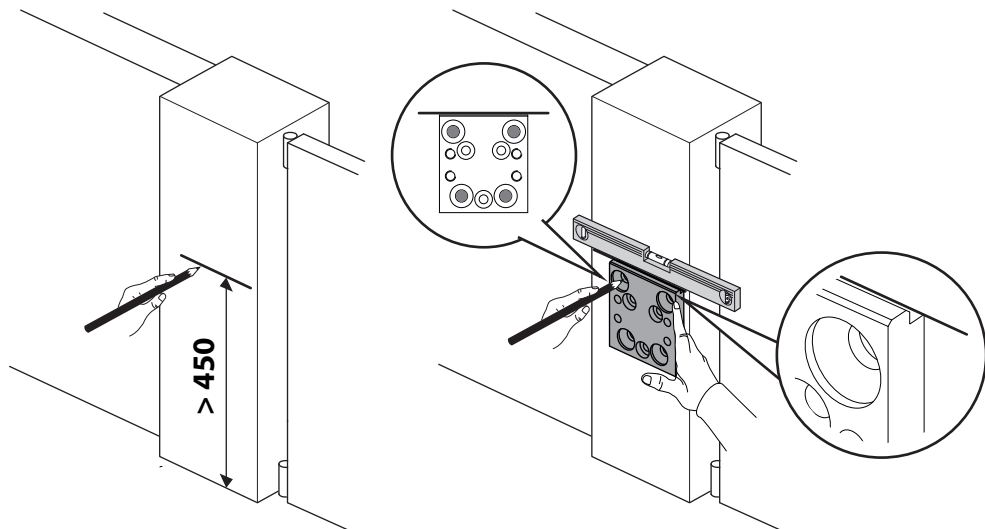
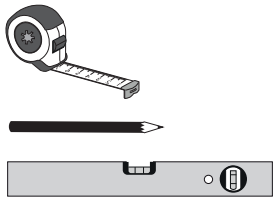

#### ON METAL

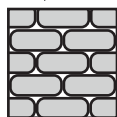
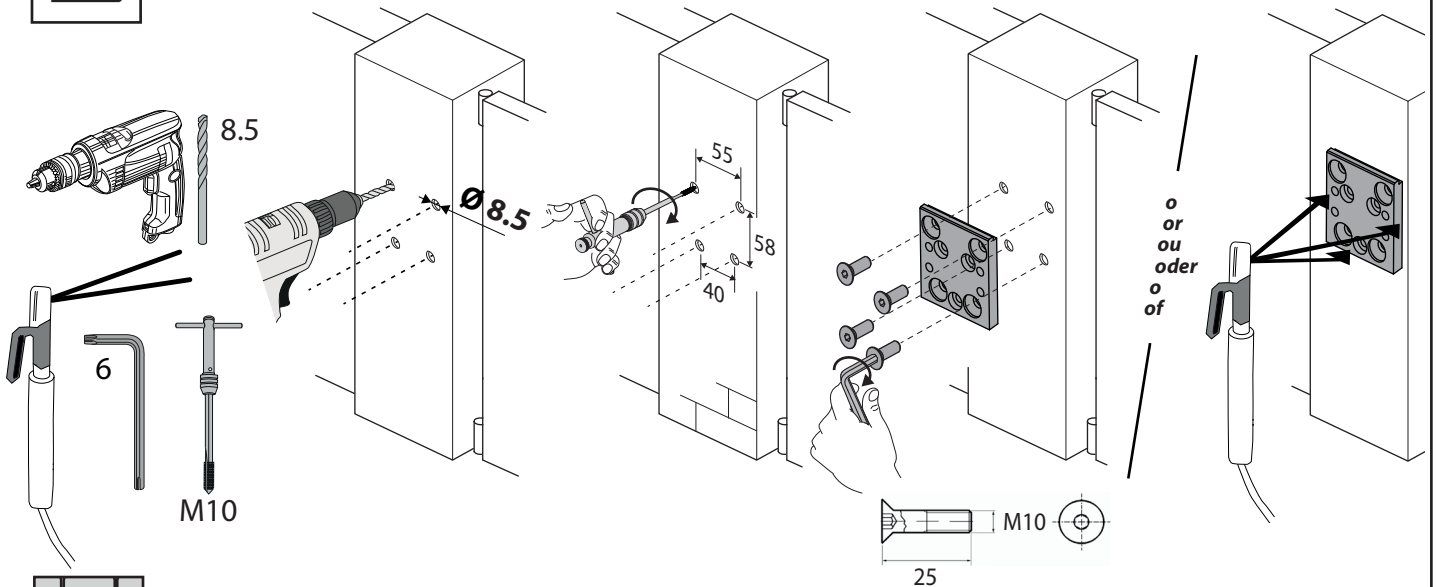

#### ON THE WALL

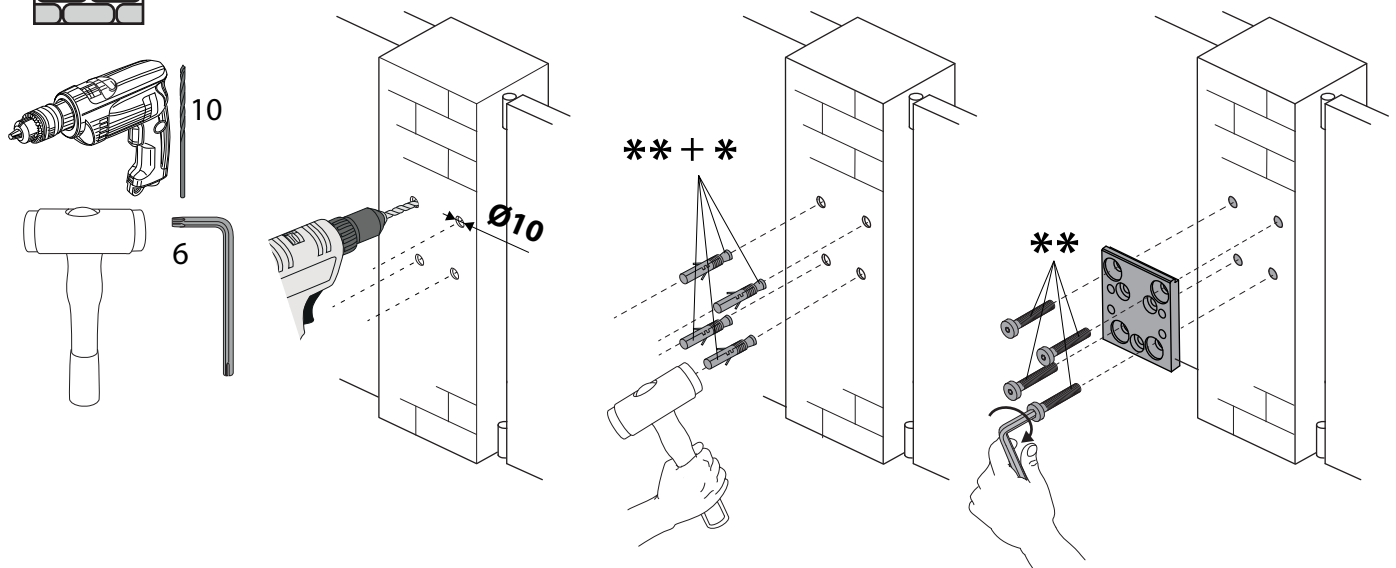

\* Use stainless steel dowels!

\*\* Not supplied!



**B**

# FASTENING OF BRACKET ON LEAF

## ARTICULATED ARM

**E5 BT A18**

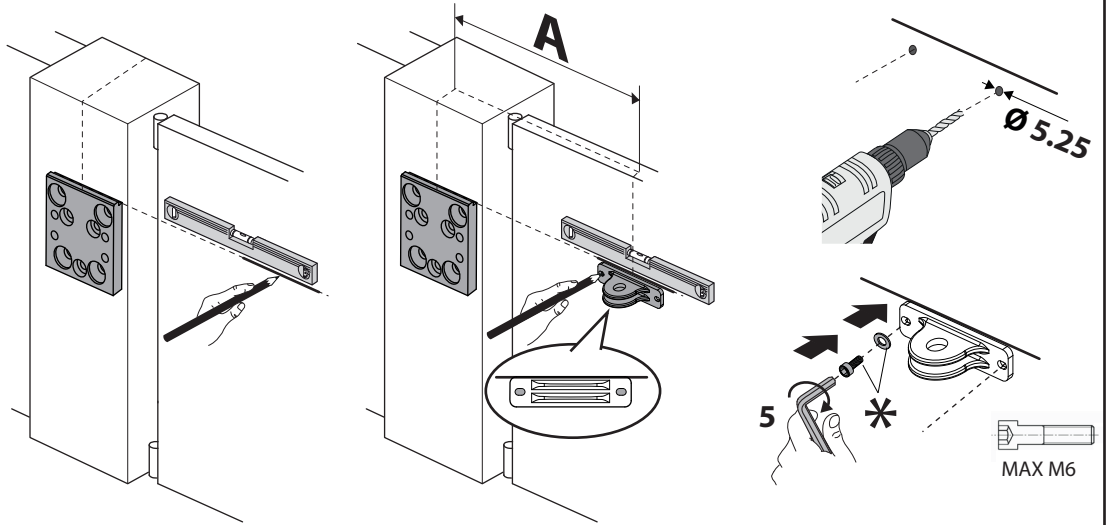
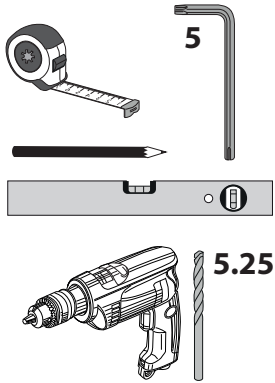

## SLED ARM

**E5 BT A18**

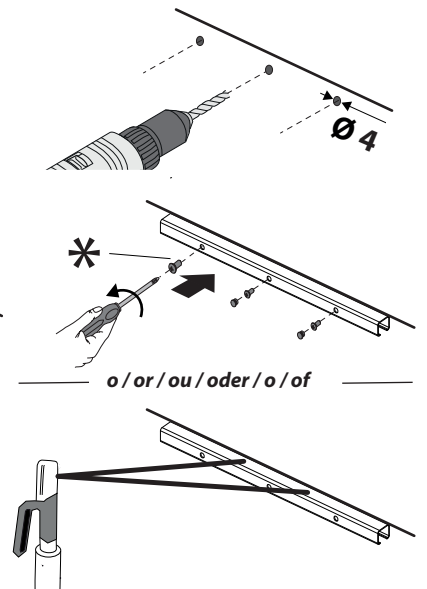
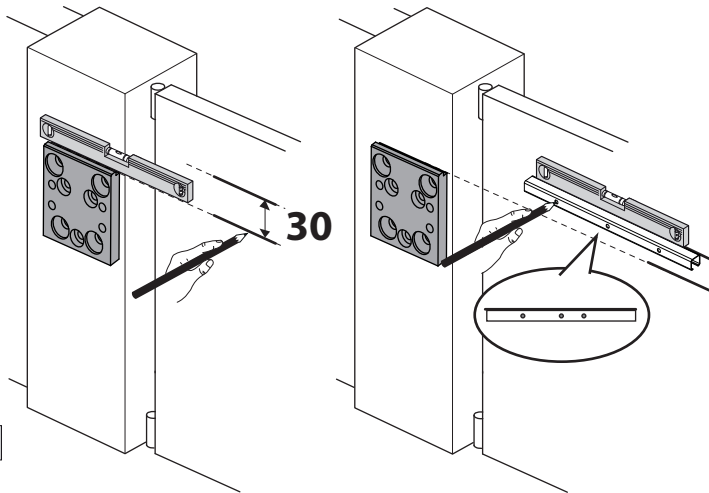
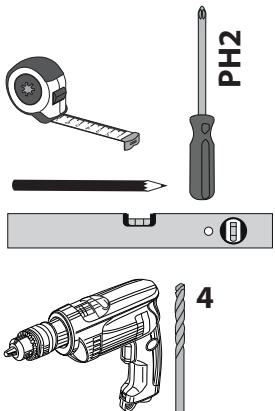

**E5 BT A12**

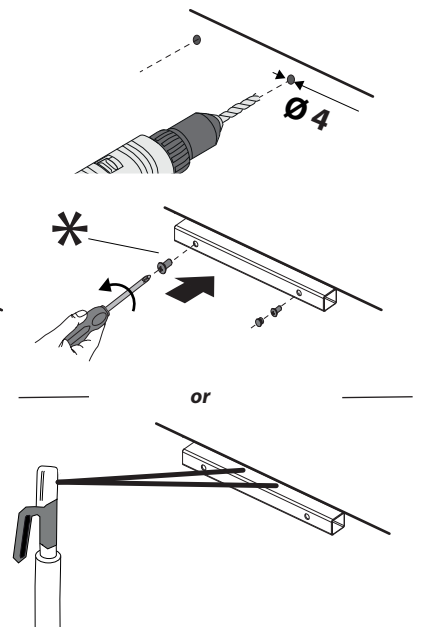
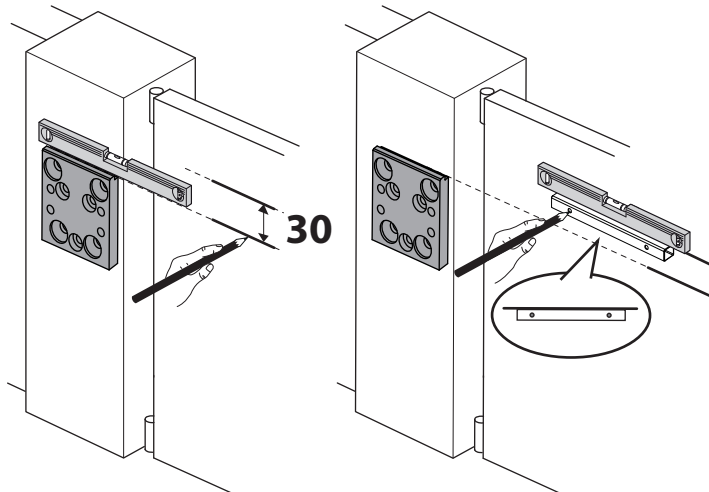
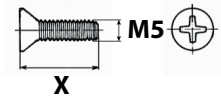

\* Not supplied

C

# CONNECTIONS

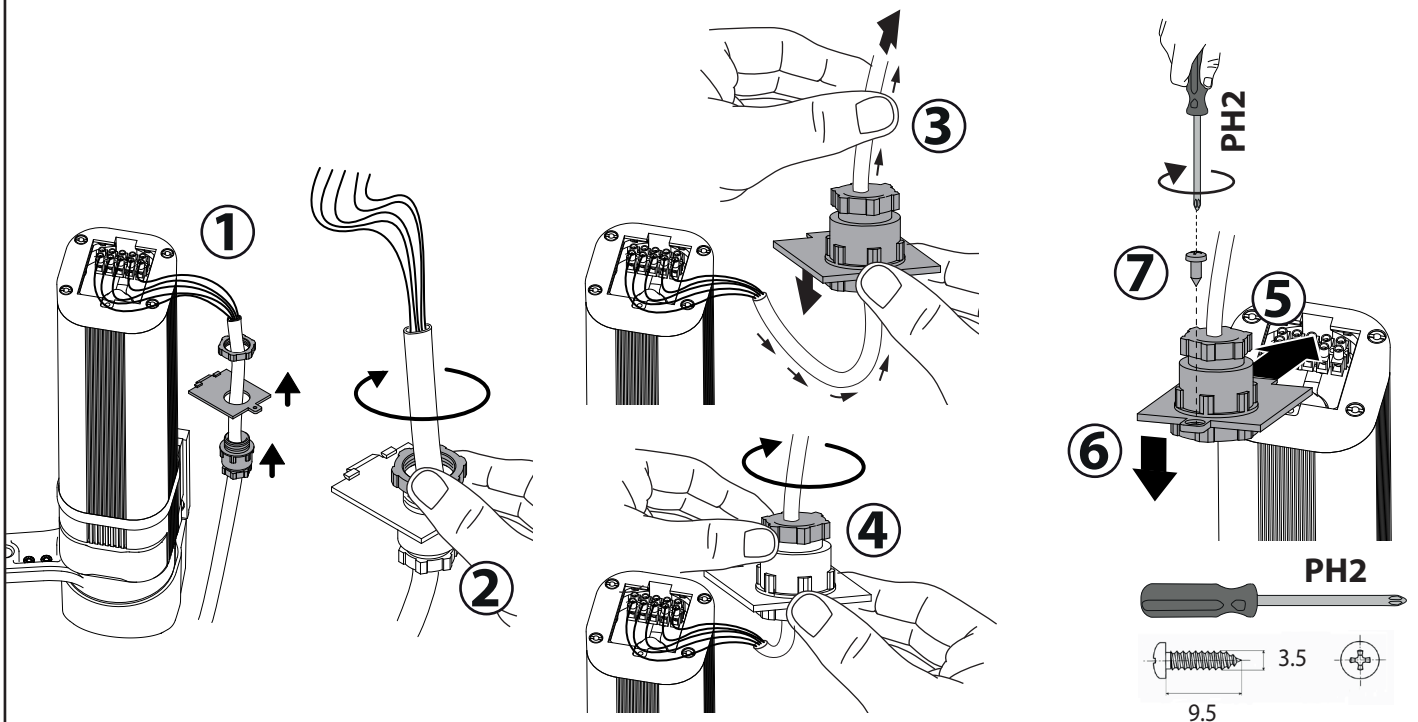
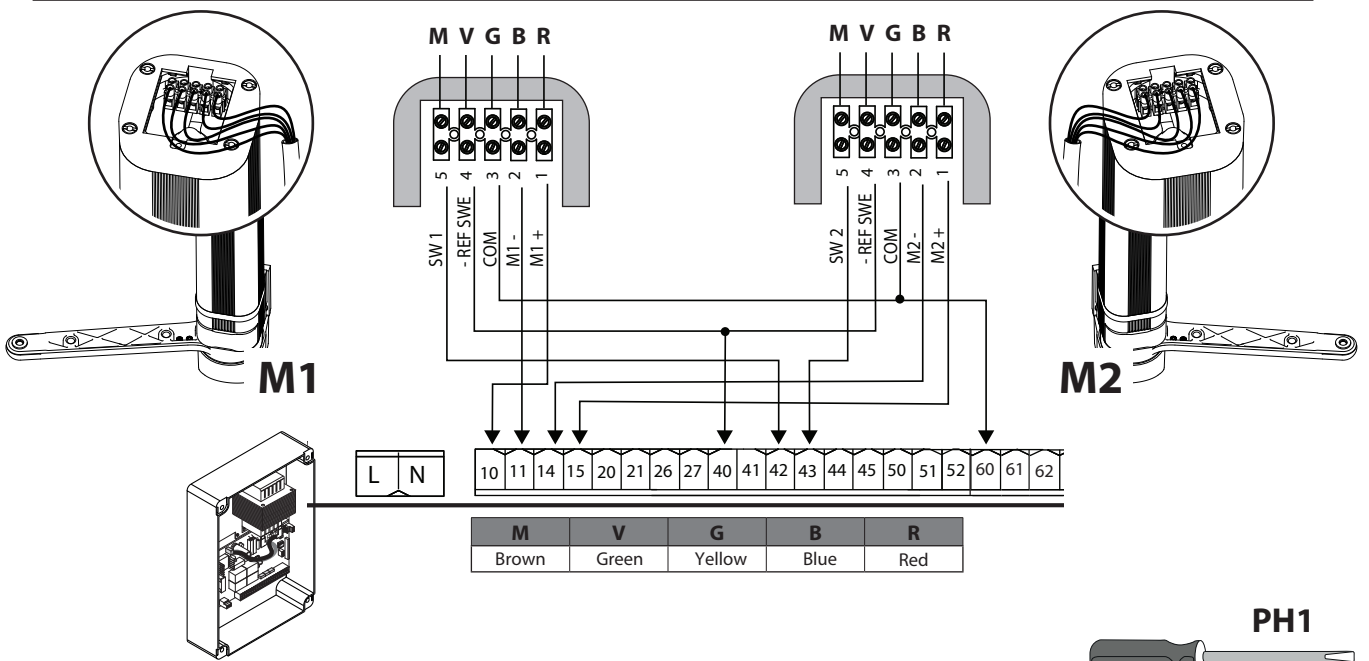
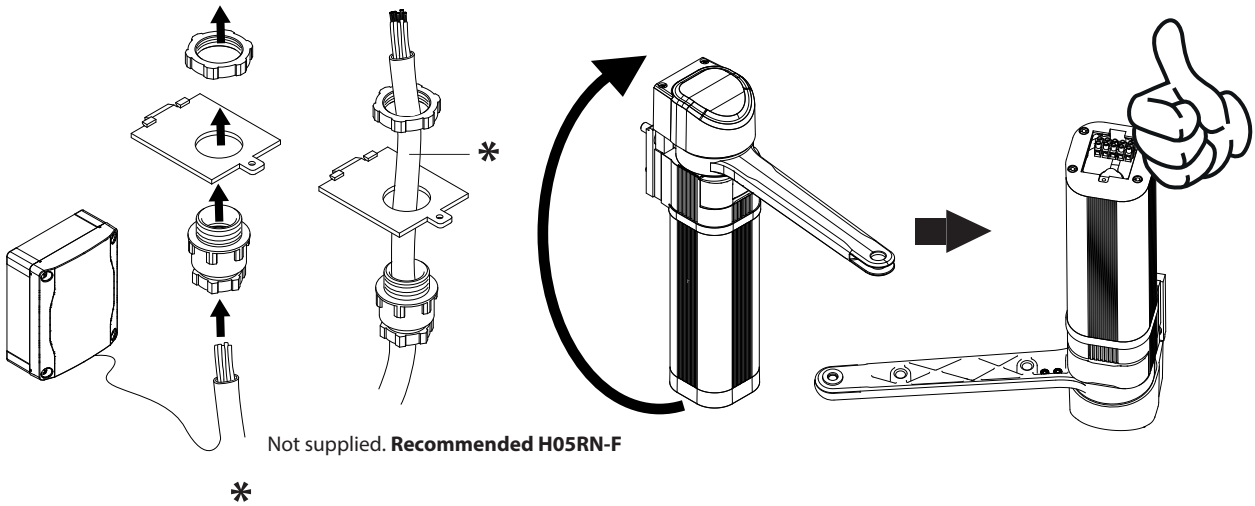

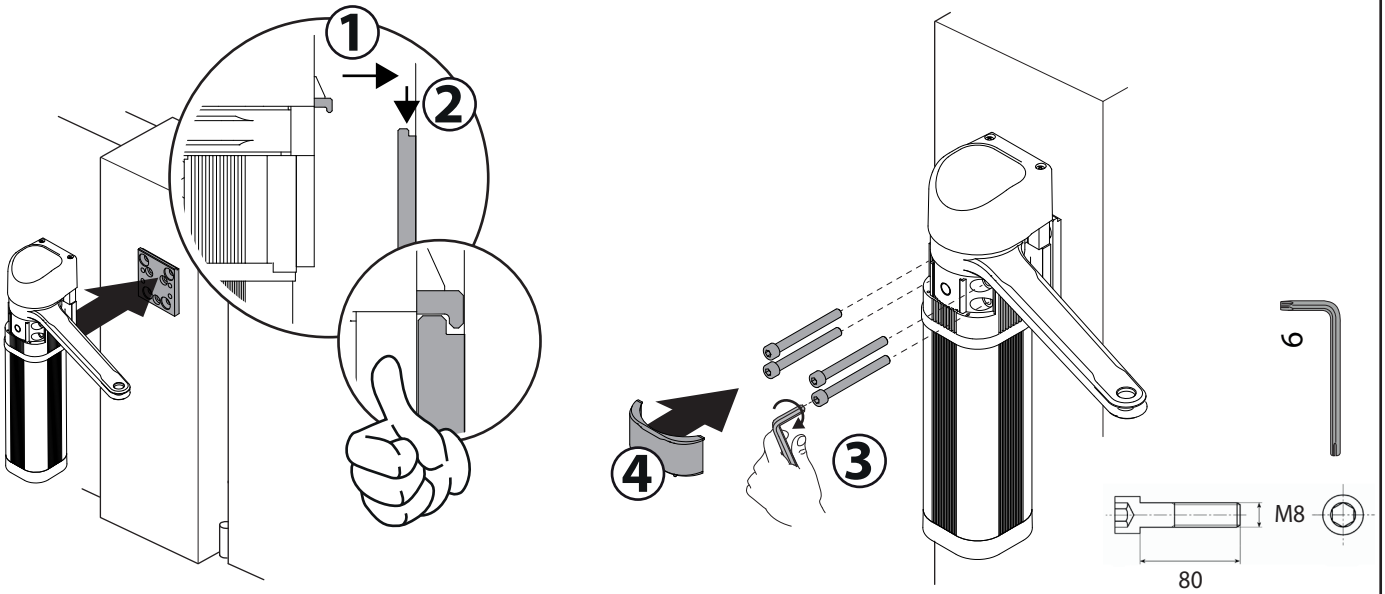
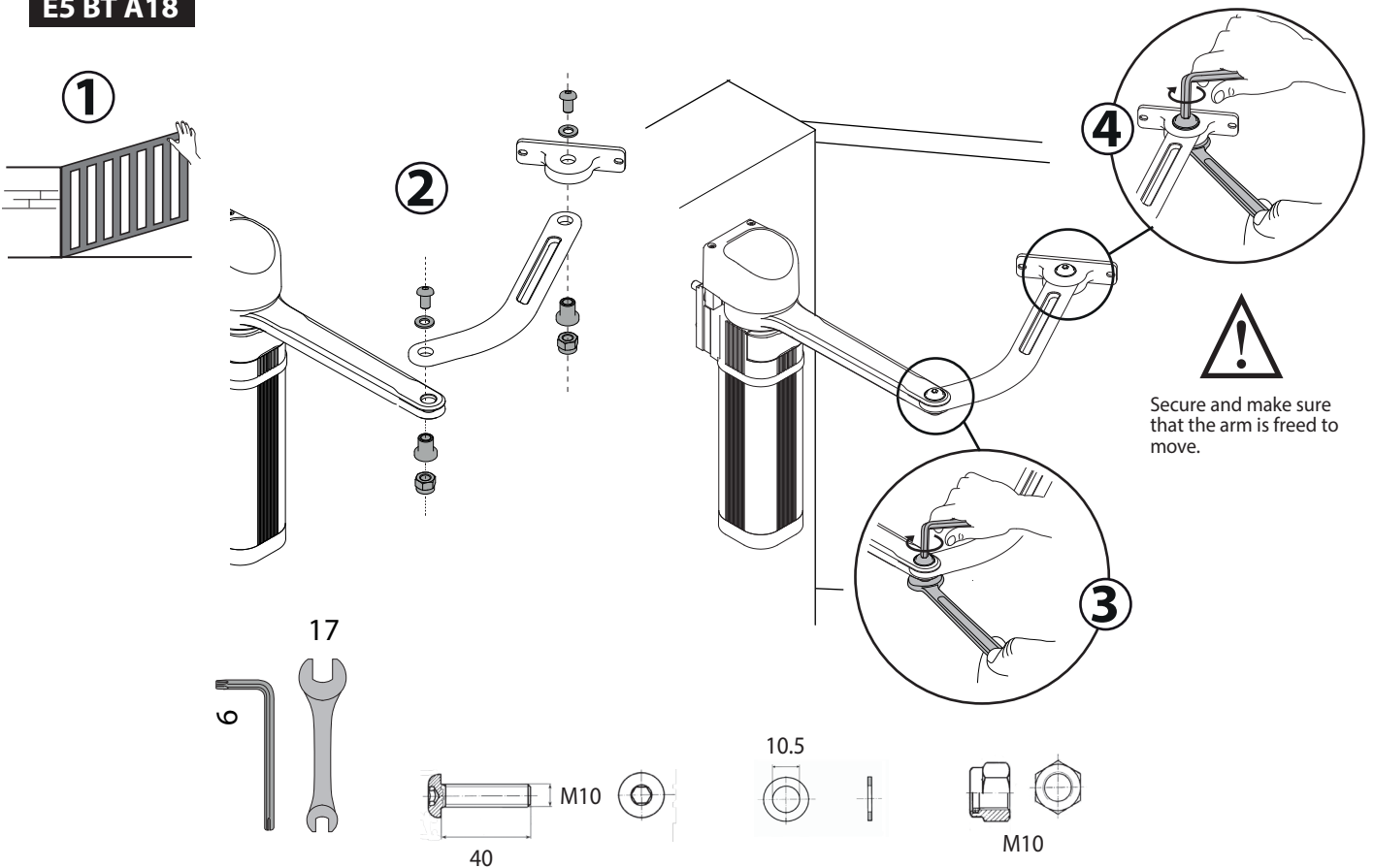
**D****MOTOR INSTALLATION****E****ASSEMBLY AND FASTENING OF ARTICULATED ARM****E5 BT A18**

F

# ASSEMBLY AND FASTENING OF SLED ARM

E5 BT A18

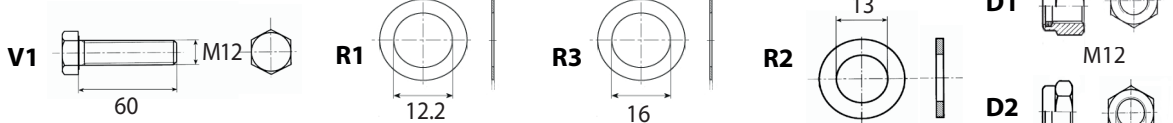
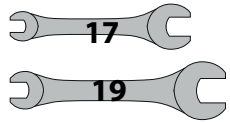
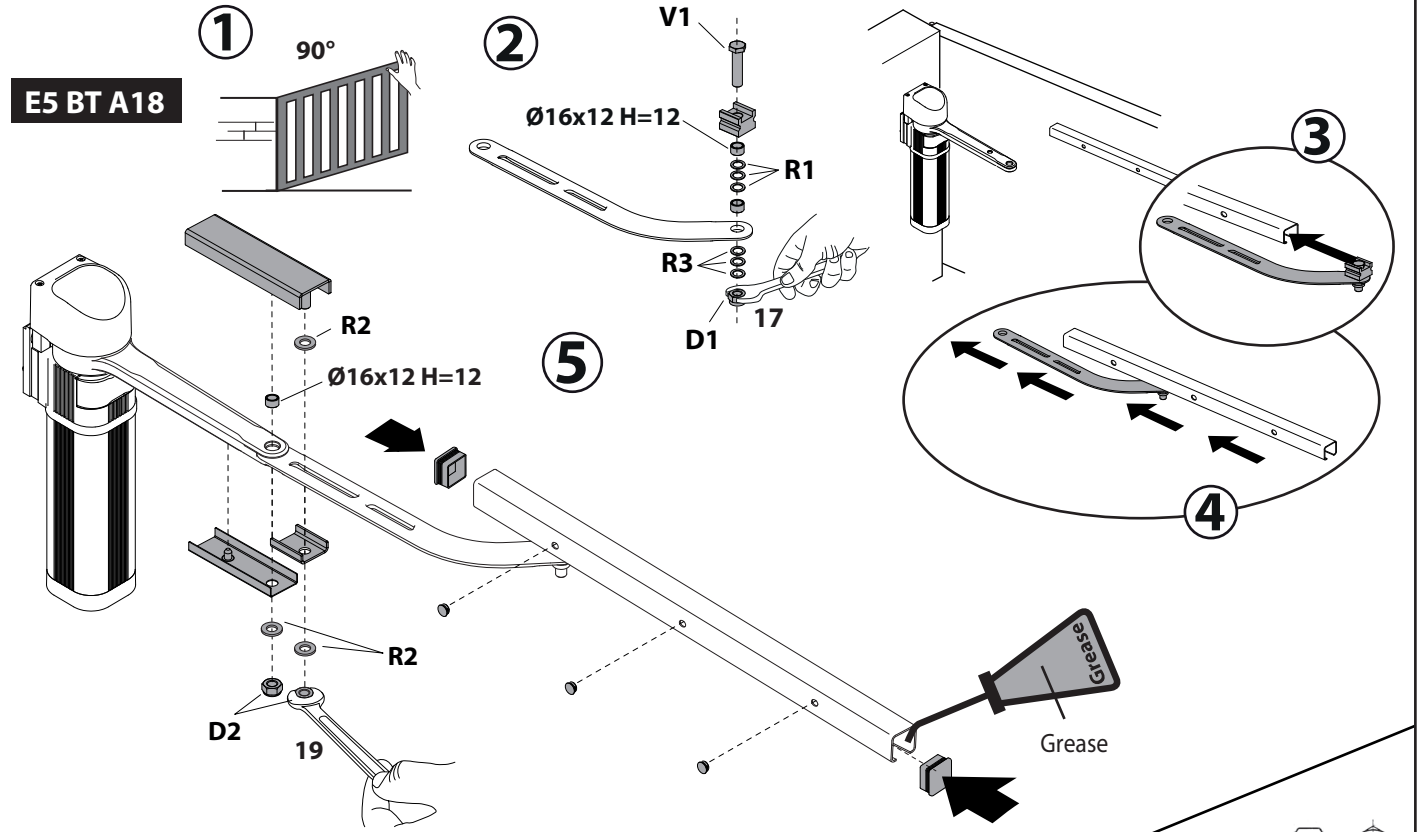

E5 BT A12

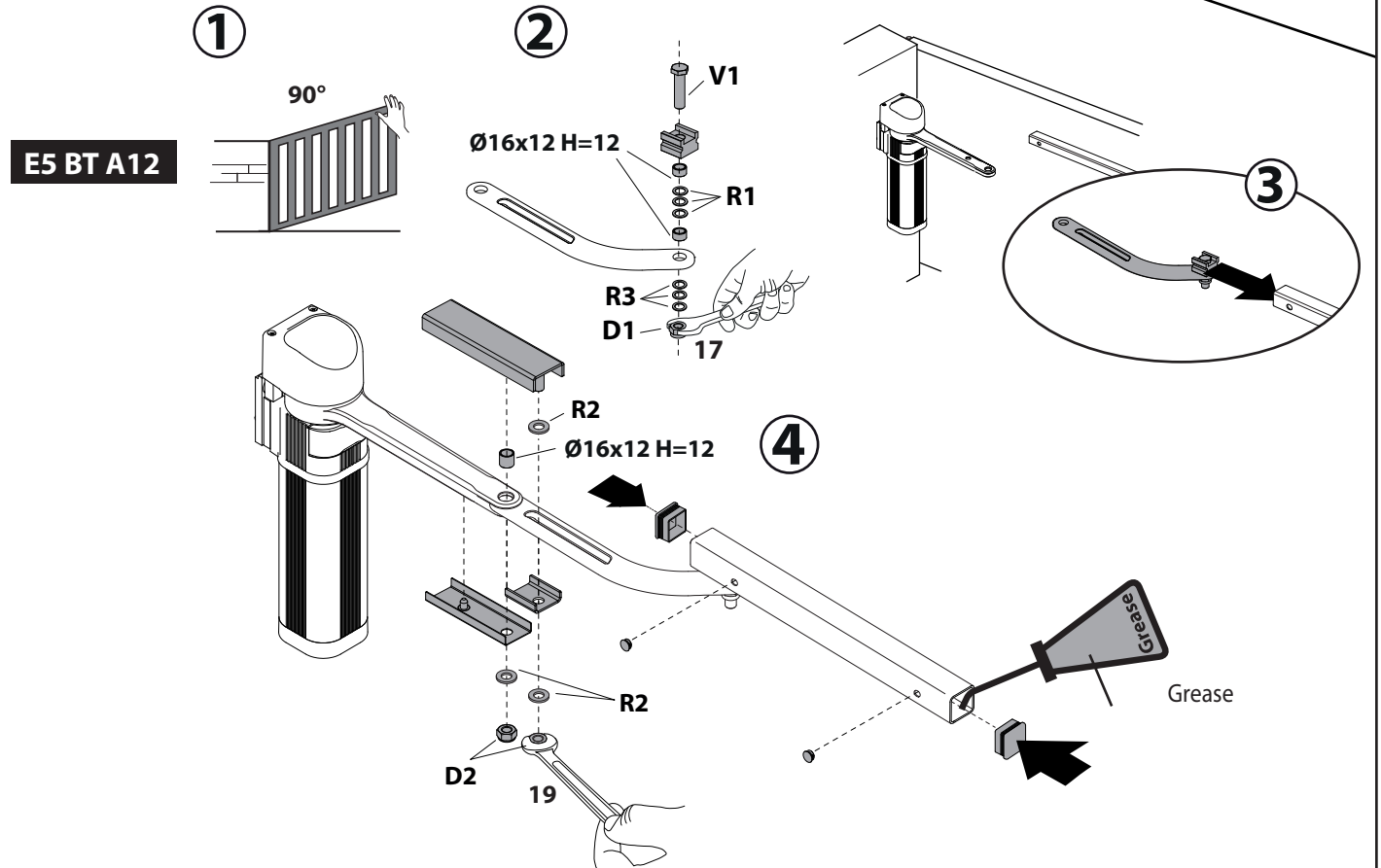

TECHNICAL DATA		E5 BT A 18	E5 BT A 12
Motor power supply	24 Vdc		
Maximum power	100W		
Length of leaf for maximum weight	1.8 m	1.2 m	
Maximum leaf weight	100 kg	80 kg	
Maximum leaf length	1.8 m	1.2 m	
Maximum motor rpm	2500	1600	
Opening time at 90° without load	14s	4.6 - 6.5s	
Block holding	reversible gear motor		
Max. motor torque	150 Nm	40 Nm	
Max. opening angle	130°		
Reaction to collision	multiple disk mechanical clutch		
Manual manoeuvre	electric lock release with key		
Max. No. of manoeuvres/h	20	100	
Environmental conditions	-20 / +55° C		
Lubrication	permanent grease		
Degree of protection	IP44		
Actuator weight	50 N (5kg)	50 N (5kg)	
Sound pressure	<70dB(A)		

\* special voltage supplies on request

**Only For E5 BT A18**

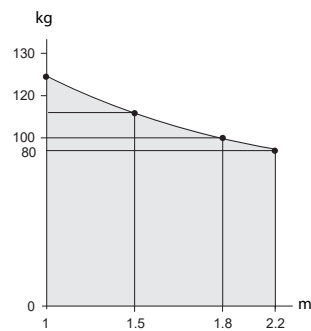

**G**

# CLUTCH FASTENING

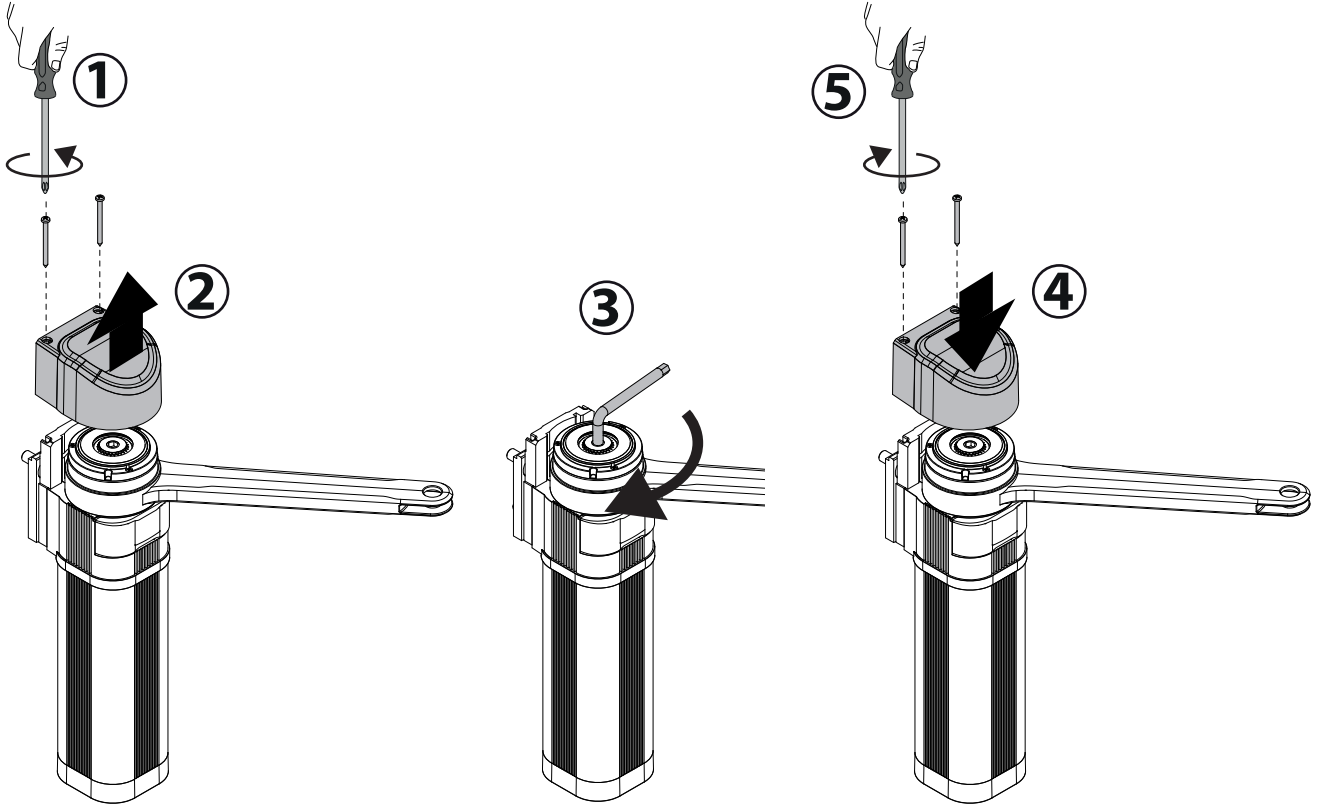

**PH2**

